

Project		Catalog #		Type	
Prepared by		Notes		Date	

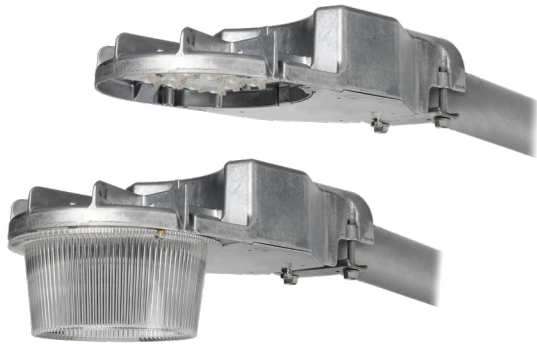

Interactive Menu

- **Ordering Information** page 2
- **Accessory & Mounting Details** page 3
- **Installation Overview** page 4
- **Energy and Performance Data** page 5
- **Optical Distributions** page 5

Streetworks

CRTK-N Caretaker Nano

Security & Utility Luminaire

Product Certifications & Features



Product Specifications

PHYSICAL CHARACTERISTICS

- All aluminum construction, with die cast housing
- Raw aluminum finish; grey powder coat optional
- Tool-less access and removable driver door for easy maintenance
- Corrosion-resistant hardware
- Mounts to pipe arms 1-5/8" to 2-3/8" OD. Optional Wall/Pole Bracket allows direct mount to wood pole or wall.
- Approximate net weight without refractor (open bottom) : 4.25lbs
- EPA (without refractor) = 0.30
- EPA (with CNR refractor) = 0.36

OPTICAL

- 4 color temperature options
 - » 70CRI: 2700K, 3000K, 4000K, 5000K
 - » T2, T3, and T5 distributions
- Optional Caretaker Nano acrylic refractor
- Compatible with ANSI/NEMA open bottom refractor assembly
- Field installable snap-on shielding (single square or perimeter fence shield)

ELECTRICAL

- 120-277V; 50/60Hz
- Standard 0-10V dimming with integrated 6kV surge protection
- 10kV and 20kV surge protection options in parallel or series configurations
- -40°C to 40°C ambient temperature operating range; -40°C to 50°C ambient temperature operating range at 20-30W

CONTROLS

- Optional Field Adjustable Dimming Control (FADC) module allows for manual adjustment of lumen output and power usage; factory preset to highest output level. Enables a single SKU to cover multiple field applications
- Fully compatible with CLS Trellix Infrastructure UNB (Ultra Narrow Band) and cellular network lighting controls platforms. Enables wireless collection of luminaire performance and status data and asset management for luminaires installed in the field

- Optional 4-pin Zhaga Book 18 receptacle for integration of onboard sensors with DALI-enabled drivers

COMPLIANCE

- Meets ANSI C136.25 for IP66 Optical enclosure rating
- Meets ANSI C136.31 for 3G luminaire vibration. Customer is responsible for engineering analysis to confirm pole and fixture compatibility for all applications
- Meets ANSI C136.15 for luminaire field identification label standard
- Meets ANSI C136.22 internal label standard
- Safety listing - Wet Location UL 1598
- U0 option provides a full cutoff with a spun aluminum shield
- DarkSky approved for 3000K CCT and warmer, with mounting options less than 10° of tilt
- DLC and DLC Premium listed- visit designlights.org to confirm listed variations
- BAA domestic preference option meets BAA requirements. See [DOMESTIC PREFERENCES](https://www.cooperlighting.com/legal) website or consult the CLS Domestic Preferences team for more information
- FHWA and FTA agencies are utilizing their BAA rules for BABA compliance. Cooper's products with a BAA designation are manufactured in the US and utilize a BAA COTS exemption rule for compliance. To verify a configured product with specific accessories and options meet BABA Domestic Preference Requirements; submit this catalog number to Cooper Lighting Quotation team for validation by our Engineering and Manufacturing teams. Please refer to the [DOMESTIC PREFERENCES](https://www.cooperlighting.com/legal) website or consult the CLS Domestic Preferences team for more information. Components shipped separately may be separately analyzed under domestic preference requirements

WARRANTY

- Five-year limited warranty. Consult website for details. www.cooperlighting.com/legal

Dimensional Details

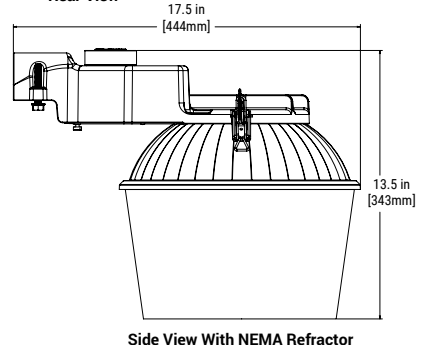
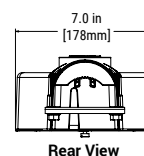
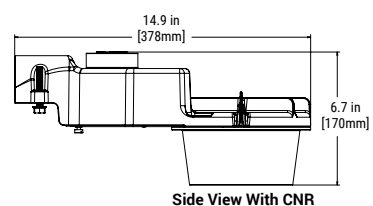
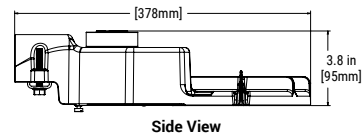
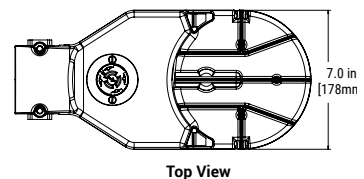

Ordering Information

SAMPLE ORDER NUMBER: CRTK-N-40-740-U-T2R-A

Product Family	Wattage Bucket	Color Temperature ⁹	Voltage	Distribution	Finish
CRTK-N =Caretaker Nano BAA-CRTK-N =Caretaker Nano, Buy American Compliant ⁷ TAA-CRTK-N =Caretaker Nano, Trade Agreements Compliant ⁷ BABA-CRTK-N =Caretaker Nano, Buy American Compliant ⁸	20 =20W (nominal) 30 =30W (nominal) 40 =40W (nominal) 50 =50W (nominal)	727 =70CRI, 2700K 730 =70CRI, 3000K 740 =70CRI, 4000K 750 =70CRI, 5000K	U =Universal (120-277V)	T2R =Type II Roadway T3 =Type III T5R =Type V Round	A =Raw Aluminum AP =Grey
Options (Add as Suffix)	Controls		Accessories (Order Separately)		
CNR =Caretaker Nano Refractor TH =Tool-less Door Hardware 10K =Series 10kV UL 1449 Surge Protection Device 10MSP =Parallel 10kV MOV Surge Protection Device 20K =Series 20kVUL 1449 Surge Protection Device ⁴ 20MSP =Parallel 20kV MOV Surge Protection Device V =(3) 5' #14 external leads B18 =18" Wood Pole Pipe Arm B24 =24" Wood Pole Pipe Arm B30 =30" Wood Pole Pipe Arm WPBKT =Wall or Pole Mounting Bracket HA =50°C High Ambient Temperature ¹ HSS =Factory Installed House Side Shield (mounted to light square) ² Dxxxxx =DOT configuration - contact factory quotes team Uxxxxx =Utility configuration - contact factory quotes team	PR7 =NEMA 7-PIN Twistlock Photocontrol Receptacle ⁴ PSC =Photocontrol Shorting Cap included LLPC =Long Life Photocontrol included FADC =Field Adjustable Dimming Controller ³ DALI =DALI Driver ⁴ D4 =D4i driver ⁴ TRXC =Trellix Cellular Network Lighting Control Node included ^{5,6}		RMARROA5 =ANSI/NEMA Standard Refractor Assembly CNR-Caretaker Nano =Caretaker Nano Refractor LLPC =Long-life Photocontrol LLPC-F0 =Long-life Photocontrol (Fail Off) OA1226 =10kV Surge Module Replacement OA/RA1013 =Shorting Cap PBHSS =House Side Shield (single) ² PBPFS =Perimeter Fence Shield kit (4 pcs) B18PK =18" Wood Pole Pipe Arm B24PK =24" Wood Pole Pipe Arm B30PK =30" Wood Pole Pipe Arm		
NOTES: 1. Can be used for 20W and 30W only. 2. Not compatible with T5R optic. 3. Not available with 20K, PR7, DALI, or D4 options. 4. Not available with FADC option. 5. Does not include Trellix software subscription (ordered separately) 6. Not currently available with B18, B24 or B30 7. BAA domestic preference option meets BAA requirements. See DOMESTIC PREFERENCES website or consult the CLS Domestic Preferences team for more information 8. FHWA and FTA agencies are utilizing their BAA rules for BABA compliance. Cooper's products with a BAA designation are manufactured in the US and utilize a BAA COTS exemption rule for compliance. To verify a configured product with specific accessories and options meet BABA Domestic Preference Requirements; submit this catalog number to Cooper Lighting Quotation team for validation by our Engineering and Manufacturing teams. Please refer to the DOMESTIC PREFERENCES website or consult the CLS Domestic Preferences team for more information. Components shipped separately may be separately analyzed under domestic preference requirements 9. DarkSky approved when ordered with 3000K or warmer CCT					

House Side Shield Details

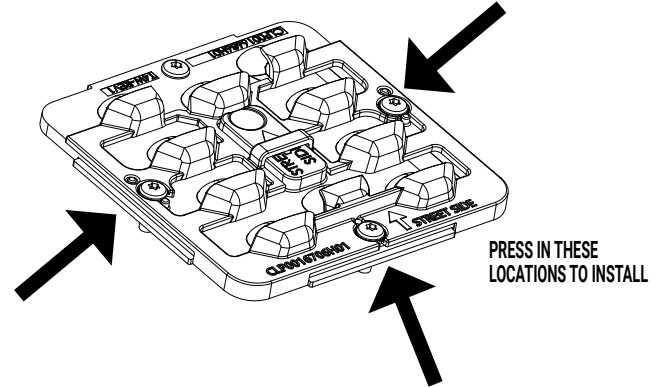
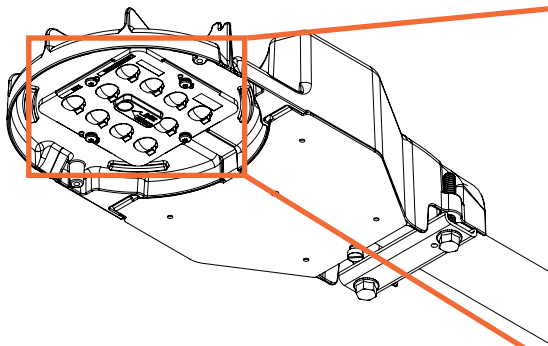

Perimeter Shield Details

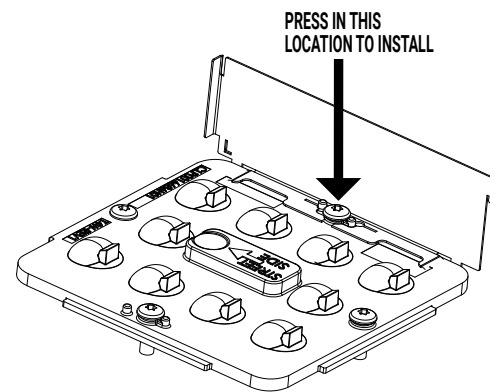
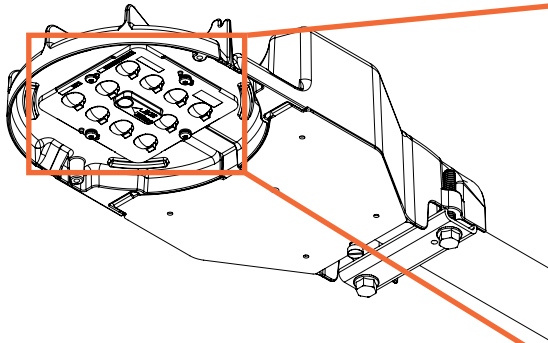

Mounting Details

Optional Wall/Pole Mounting Bracket

Wall Mount / Square Pole Mount

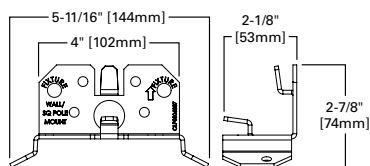

Pole Mount

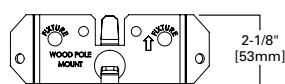

Optional Wood Pole Pipe Arm

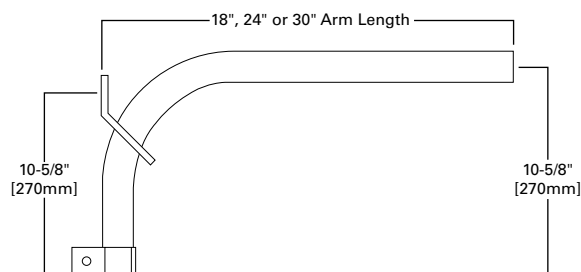

Installation Overview

Quick Instruction Steps:

1. Loosen Mounting Bolts for Pole Clamp
2. Insert Pole Arm Into Fixture
3. Tighten Mounting Bolts on Pole Clamp
4. Open Door by Unscrewing the Door Screw
5. Pull Wires into Housing Through Rear Slot and Wire Appropriately
6. Close fixture Door with Door Screw

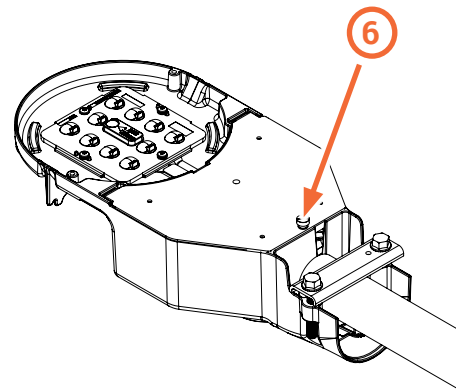
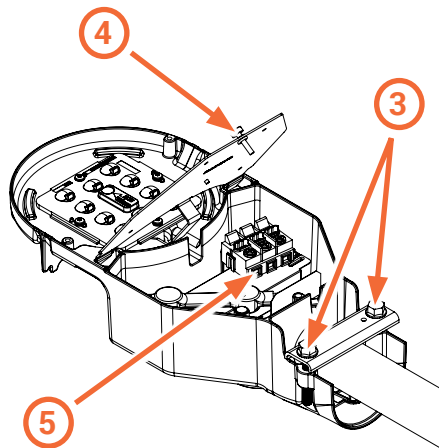
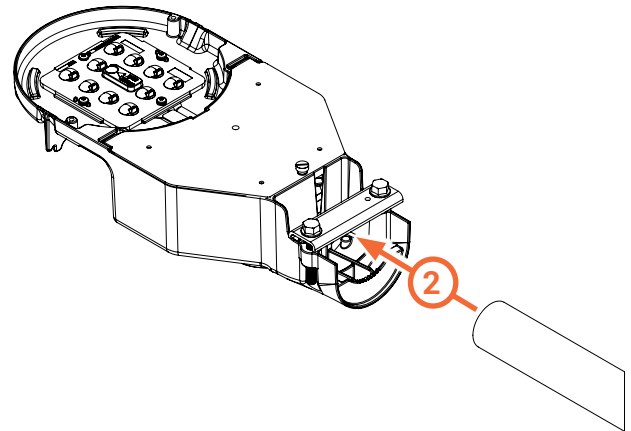
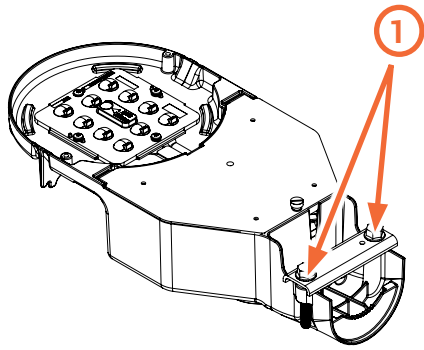

Energy and Performance Data

Nominal Power (Watts)	20	30	40	50
Actual Power (Watts)	23	32	42	48
Wattage Label	20	30	40	50
Input Current @ 120V (A)	0.19	0.27	0.35	0.40
Input Current @ 277V (A)	0.08	0.12	0.15	0.17

70 CRI, 3000K					
T2R	Lumens	3,423	4,477	5,527	6,060
	Lumens per Watt	148	139	131	127
	BUG Rating	B1-U0-G1	B1-U0-G1	B1-U0-G1	B1-U0-G1
T2R w CNR	Lumens	3,319	4,342	5,360	5,876
	Lumens per Watt	143	134	127	123
	BUG Rating	B1 U0 G1	B1 U0 G1	B1 U0 G1	B2 U0 G2
T3	Lumens	3,410	4,460	5,506	6,036
	Lumens per Watt	147	138	131	127
	BUG Rating	B1-U0-G1	B1-U0-G1	B1-U0-G1	B1-U0-G1
T3 w CNR	Lumens	3,307	4,325	5,340	5,854
	Lumens per Watt	143	134	127	123
	BUG Rating	B1-U3-G1	B2-U3-G2	B2-U3-G2	B2-U3-G2
T5R	Lumens	3,493	4,570	5,641	6,185
	Lumens per Watt	151	141	134	130
	BUG Rating	B2-U0-G1	B3-U0-G1	B3-U0-G1	B3-U0-G1
T5R w CNR	Lumens	3,362	4,398	5,429	5,952
	Lumens per Watt	145	136	129	125
	BUG Rating	B2-U3-G1	B2-U3-G2	B3-U3-G2	B3-U3-G2

70 CRI, 4000K					
T2R	Lumens	3,594	4,701	5,804	6,363
	Lumens per Watt	155	146	138	133
	BUG Rating	B1-U0-G1	B1-U0-G1	B1-U0-G1	B2-U0-G2
T2R w CNR	Lumens	3,485	4,559	5,627	6,170
	Lumens per Watt	150	141	134	129
	BUG Rating	B1-U3-G1	B2-U3-G2	B2-U3-G2	B2-U3-G2
T3	Lumens	3,580	4,683	5,781	6,338
	Lumens per Watt	154	145	137	133
	BUG Rating	B1-U0-G1	B1-U0-G1	B1-U0-G1	B1-U0-G1
T3 w CNR	Lumens	3,472	4,542	5,607	6,147
	Lumens per Watt	150	141	133	129
	BUG Rating	B1-U3-G1	B2-U3-G2	B2-U3-G2	B2-U3-G2
T5R	Lumens	3,668	4,798	5,923	6,494
	Lumens per Watt	158	149	141	136
	BUG Rating	B2-U0-G1	B3-U0-G1	B3-U0-G1	B3-U0-G1
T5R w CNR	Lumens	3,530	4,617	5,700	6,250
	Lumens per Watt	152	143	135	131
	BUG Rating	B2-U3-G1	B3-U3-G2	B3-U3-G2	B3-U3-G2

Lumen Maintenance

Ambient Temperature	25,000 hours*	50,000 hours*	60,000 hours*	100,000 hours*	L70*
25°C	98.1%	96.3%	95.6%	92.8%	>102,000
40°C	98.0%	96.1%	95.3%	92.3%	>102,000
50°C	97.8%	95.6%	94.8%	91.4%	>102,000

Note: * Calculations provided in accordance with IES TM-21-11 using the configuration resulting in highest LED temperature.

Lumen Multiplier

Ambient Temperature	Lumen Multiplier
0°C	1.02
10°C	1.01
25°C	1.00
40°C	0.99
50°C	0.97

FADC Settings

FADC Position	Percent of Typical Lumen Output
1	25%
2	48%
3	56%
4	65%
5	75%
6	80%
7	85%
8	90%
9	95%
10	100%

Note: +/-5% typical value

LED Color Multipliers

CRI	CCT			
	2700	3000	4000	5000
70	Lumen Multiplier*			
	0.92	0.95	1.00	1.00

Note: * Estimates, refer to IES files for accuracy.

Optical Distributions

